

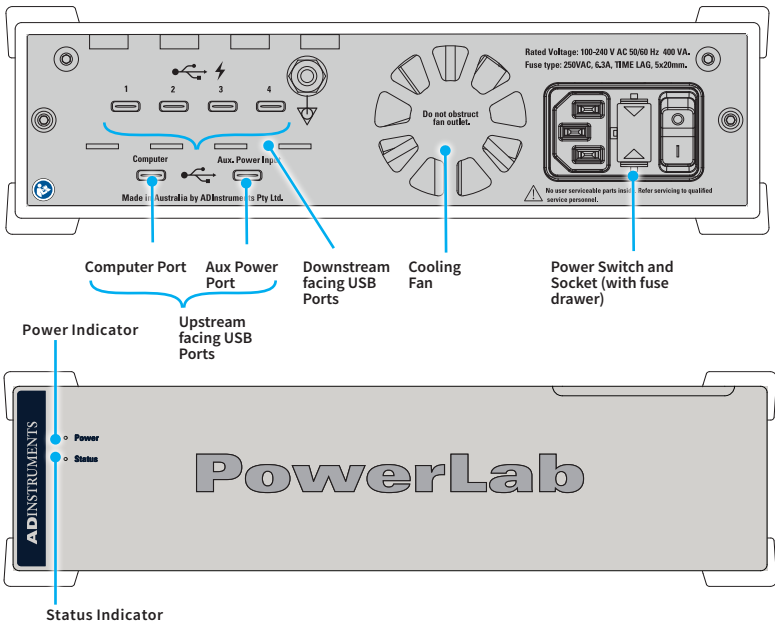

### The PowerLab C is the center of the C Series Device Ecosystem. To get started:

1. Connect the included power cable and switch on the power
2. Connect the 'Computer' port to your PC using one of the included cables
3. Connect any C Series Devices you have to any of the 'Downstream facing USB Ports'
4. Check the 'Power' LED is blue
5. Download & install the latest copy of LabChart or LabChart Lightning from [adstruments.com](http://adstruments.com)



For more information, including how to use multiple PowerLabs simultaneously, alternate methods for powering your PowerLab C and troubleshooting, please refer to the full Owners Guide at [adi.to/powerlabstart](http://adi.to/powerlabstart).